

MEDINA COUNTY  
66<sup>th</sup> ANNUAL  
**SOLO AND ENSEMBLE FESTIVAL**

BUCKEYE HIGH SCHOOL

THIS FESTIVAL IS HELD UNDER THE  
AUTHORITY OF THE ESC OF MEDINA COUNTY  
GOVERNING BOARD.

ROBERT A. HLASKO, ED.D., SUPERINTENDENT



JEFFREY STANTON, SUPERINTENDENT  
BUCKEYE LOCAL SCHOOLS

ADAM SNOOK, PRINCIPAL  
BUCKEYE HIGH SCHOOL

GREG KING, FESTIVAL CO-COORDINATOR

PAM HABERKORN, FESTIVAL CO-COORDINATOR

SATURDAY  
JANUARY 27, 2024



# THANK YOU

*The Buckeye Band Boosters Appreciate and  
Thank You for Your Support.*

Coffee/Tea/Water	\$1.00
Donuts	\$2.00
Snacks, a la carte	\$1.00

## ***Special Thanks to Our Individual Sponsors***

*Dr. Mary Crabtree*

*Kent and Wendy Morgan*

*Kimberly States*

*Brenda Zacharias*



The Educational Service Center of Medina County will be the leader in fostering positive partnerships within our community by providing services and support that promote excellence in education.

Dear Students and Spectators:

Welcome to the 66<sup>th</sup> annual Medina County Solo and Ensemble Festival! Through the collaboration of the ESC of Medina County and music directors from the participating Medina County school districts, this event has provided a creative outlet in a competitive format for generations of talented students.

Whether in the classroom, on the field, or on the stage, Medina County students demonstrate amazing talents every year. The time and dedication these students (and their directors) put into their craft is beyond comprehension. I am certain this year's group of talented artists will no doubt impress us! The Solo and Ensemble Festival provides an ideal outlet for both individual and group performances in a setting of friendly competition. We encourage you to support each student and school in that manner.

A huge thank-you to Buckeye Local Schools for their efforts and for the generous use of their facilities for this event. It is a testament to the dedication of the educators and the schools they represent in coming together to plan for and facilitate an event such as this in order to put the spotlight where it belongs—on the amazing students of Medina County.

Finally, a thank-you to the audience for celebrating the students here today! Enjoy the show!

Sincerely,

Robert A. Hlasko, Ed.D.  
Superintendent  
ESC of Medina County





# BUCKEYE LOCAL SCHOOLS

**BELIEVE • EMPOWER • ACHIEVE**

## ADMINISTRATION

**Jeffrey M. Stanton**  
Superintendent

**Jennifer Knapp**  
Treasurer

**Bridget M. Elias**  
Director of Curriculum

**Dawn Kochanek**  
Director of Student  
Services

**Jon List**  
Director of Operations

## BOARD OF EDUCATION

**Seth Kujat**  
President

**John Girard**  
Vice President

**Barbara Gunkelman**  
Board Member

**Denise Piovarchy**  
Board Member

**Roy Salazar**  
Board Member

January 24, 2024

Welcome Guests:

On behalf of everyone from the Buckeye Local School District, please accept my welcome to this year's Solo and Ensemble Festival. We are very happy to be your host, and hope you truly enjoy this wonderful event.

The impressive dedication of students, teachers, family, and supporters deserves recognition. Thank you to everyone who has contributed to the success of these outstanding students who are the focus of the event. I wish the best of luck to all participants, and I hope everyone has a rewarding and enjoyable experience while at the festival.

Sincerely,

Jeffrey M. Stanton  
Superintendent



# BUCKEYE HIGH SCHOOL

## Floor Plan

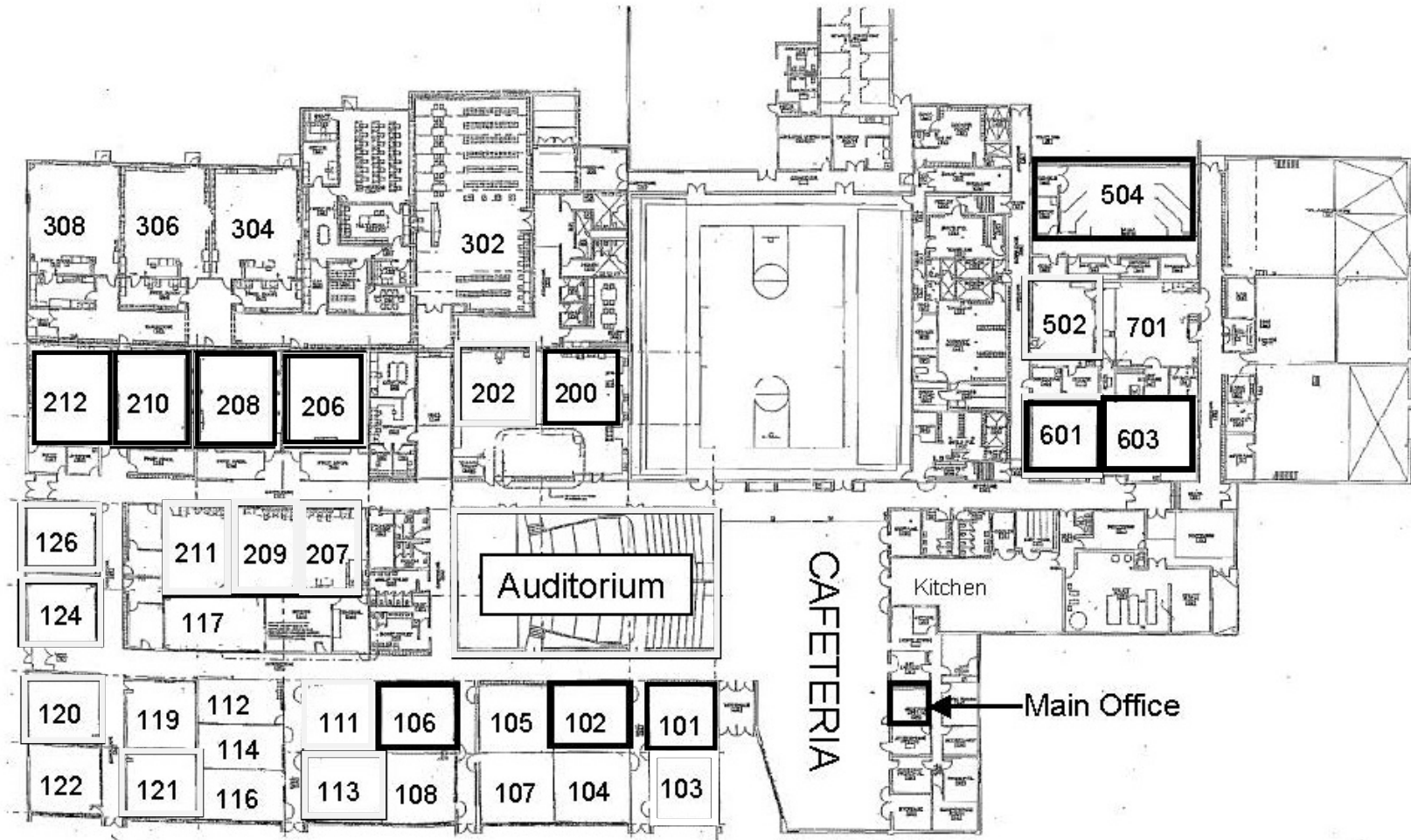

### Adjudication Rooms

Room 101	Amy Doty
Room 102	Dan Doty
Room 106	Michael Foster
Room 504	Michael McClintock

### Adjudicator Room

Main Office    Adjudicators' Meeting Room

### Homerooms/Warm-Up Room

Brunswick	Room 212
Buckeye (instrumental)	Room 601
Buckeye (vocal)	Room 603
Highland (strings)	Room 206
Highland (wind/perc)	Room 208
Piano (warm-up)	Room 200
Private	Room 210





# Table of Contents

**Participating Schools and Adjudicators** ..... ii

## Rules and Regulations

A Note to Parents, Participants, and Directors ..... iii  
 Comment Sheets ..... iii  
 Conduct ..... iv  
 Directions to Music Directors ..... iv  
 Event Cancellations, Conflicts, and Schedule Changes ..... v  
 Festival Management ..... v  
 Homerooms and Warm-Up Rooms ..... v  
 Illness ..... v  
 Music and Adjudicator's Score ..... vi  
 Music Requirements ..... vi  
 Performance Stages ..... vii  
 Programs ..... vii  
 Ratings ..... vii  
 Scale Requirements ..... viii  
 Time Schedule ..... ix  
 Unloading and Parking ..... ix

## Adjudication Schedule

Instrumental ----- Amy Doty ----- Room 101 ..... 1  
 Instrumental ----- Michael McClintock ----- Room 504 ..... 3  
 Strings ----- Michael Foster ----- Room 106 ..... 5  
 Vocal/Keyboard ----- Dan Doty ----- Room 102 ..... 6

## Special Thanks to Our Sponsors and Patrons

HOMEROOMS		WARM-UP ROOM	
Brunswick	Room 212	Piano	Room 200
Buckeye (instrumental)	Room 601		
Buckeye (vocal)	Room 603		
Highland (strings)	Room 206		
Highland (wind/perc)	Room 208		
Private	Room 210		
Adjudicators	Main Office		

## *Participating Schools and Directors*

### Brunswick City Schools

Adam Albright  
Gary Allen  
Jeannette Timko

### Highland Local Schools

Vince Ciulla  
Laura Joss  
Ed Marquette  
Nate Rudolph

### Buckeye Local Schools

Pam Haberkorn  
Greg King  
Alison MacDonald

### Private Instructors

Melinda Kline  
Tom Pylinski  
Kimberly States  
Emily Stauch

## *Adjudicators*

Amy Doty  
Dan Doty  
Michael Foster  
Michael McClintock

Black River Local Schools  
Private music teacher, Wadsworth  
Copley-Fairlawn City Schools  
Highland Local Schools

## *Festival Management*

Pam Haberkorn  
Greg King  
Brenda Zacharias

Festival Co-Coordinator, Buckeye HS and JH  
Festival Co-Coordinator, Buckeye HS and JH  
Secretary, ESC of Medina County

# RULES AND REGULATIONS

## A Note to Parents, Participants, and Directors

Music directors and the Educational Service Center of Medina County have structured the Medina County Solo and Ensemble Festival so that it falls in line with the Ohio Music Education Association (OMEA) rules and guidelines for festival competitions. With that thought in mind, we are providing these festival rules and regulations for your information.

The Medina County Solo and Ensemble Festival provides music students in Grades 5-12 (and fourth-grade piano students) with the opportunity to perform, display their talents, and receive constructive comments as well as a rating for their performances by a qualified adjudicator. Students are eligible to participate if they are enrolled in a Medina County school district currently under contract with the ESC of Medina County for Fine Arts Festival services. For this school year, that includes: Black River, Brunswick, Buckeye, Cloverleaf, Highland, Medina, and St. Francis Xavier School.

Adjudicators will continue to take an active role in helping students grow as participants, whether they will be participating in the OMEA Solo and Ensemble Festival this year or simply attending our county festival. Further, the management of this festival urges directors to allow students to participate either for rating or for comments only in an attempt to encourage students to participate in the event. The festival is to be used as a tool for performance improvement while garnering positive musical experiences for young musicians.

Please take a moment to review the next few pages. If you have comments and/or suggestions on the running of this festival, please address your comments to:

Robert A. Hlasko, Ed.D.,  
Superintendent  
ESC of Medina County  
330/723-6393

Greg King, Festival Coordinator  
Buckeye High School  
330/722-8257, Ext. 3038

## Comment Sheets

Music teachers and directors will be responsible for picking up rating sheets and adjudicator music from the main school office on the day of the event. Comment sheets and music not picked up on the day of the event will be sent to the music teacher/director via ESC courier mail during the week following the event.

**Only the director or authorized personnel may pick up these sheets.** Parents, guardians, and students will not be permitted to pick up any rating sheets.

## Conduct

Please remind your students not to deface any property or remove posters/signs from the building. Please use trash containers for all waste materials. No food or beverage is allowed outside of the food serving area. Students smoking, drinking, or using any form of illegal drugs will be disqualified from the festival and turned over to the legal authorities.

## Directions to Music Directors

- A. Schools may send as many soloists and ensembles in any event as they desire. However, it is recommended that a student **NOT** enter more than three solo and/or ensemble events. A student may **NOT** compete in the same type of event more than once per year (e.g., flute solo).
- B. A group with **3-24 members** is considered an **ensemble**. A group with **25-60 members** will be considered an elementary **choir** or **band**.
- C. The total number of students enrolled in an elementary band or choir may participate as long as they rehearse as a choir and all come from the same school. Doubling of parts in all groups is permissible.
- D. Members of duets **MUST** be performing **DIFFERENT** parts (no unison playing/singing). A duet, by definition, means two performers, and no more than two performers will be considered a duet.
- E. Recorder solos and ensembles are permitted and will follow the same rules as for instrumental and vocal solos.
- F. The use of photographed or otherwise reproduced copies of published music, without permission of the publisher, is in violation of the ESC of Medina County's policy and United States copyright laws. In cases where scores are "out of print," the director may secure permission from the publisher to reproduce the scores. The director should present the letter of permission from the publisher or music dealer to the adjudicator.
- G. In determining eligibility for junior high/middle school students, if your school building houses sixth graders, your students are considered junior high/middle. If sixth graders are housed at the elementary level, sixth graders are considered as elementary students.
- H. Directors will be permitted to use CDs, MP3 recordings, or Smart Music Studio to assist with accompaniment. The decision will be the director's, and the director is responsible for bringing his/her own equipment.

## **E**vent Cancellations, Conflicts, and Schedule Changes

If you have any event cancellations, report them to the festival office as soon as you arrive at the festival site. A runner will notify the appropriate room chair of the cancellation(s).

Conflicts in scheduling should be reported to the appropriate room chairs first. If no solution seems evident, contact the site host or festival chair. Schedule changes will be at the option of the adjudicator.

## **F**estival Management

- A. To be accepted, entries must be received by Friday, **January 12**.
- B. Any entry not completed correctly will be returned to the applicant's director.
- C. Directors are expected to be in attendance during the times that their students are participating. If this is impossible, someone from that school should be predetermined as "director of responsibility" for those students. Rating sheets will not be given to students or parents the day of the event.
- D. It is the responsibility of each director to notify the festival chair of any conflicts that might prevent the festival from running on time. Such conflicts will be honored **ONLY** if written notification on the application form is available.

## **H**omerooms and Warm-Up Rooms

All contestants should report to their homerooms/warm-up rooms at least 20 minutes prior to their performance time. Contestants are expected to appear at their performance room at least one event prior to their scheduled time.

All cases, wraps, etc., should be taken to your assigned homeroom upon arrival at the festival site. Each school district shall be responsible for leaving its room(s) neat and clean. An adult representative or parent should be in your homeroom during the hours of your participation. The site school will take no responsibility for lost or stolen items.

## **I**llness

Students not feeling well on the day of the event should contact their director and request to be excused from participating. Likewise, directors not feeling well on the day of the event should arrange for a "director of responsibility" to cover their events.

## Music and Adjudicator's Score

Contestants must submit full scores in ensemble events and satisfactory non-duplicated copies of solos. (A piano score for either IS acceptable.) The adjudicator will indicate the rating the performer deserves but must report on the rating sheet, for the benefit of the festival, if the copy submitted is satisfactory.

All manuscript ensemble scores must be accurate, readable, and complete. Refer all doubtful cases to the festival chair.

All adjudicator's scores must be numbered from beginning to end. Failure to have fully numbered adjudicator's scores will result in lowering of the final rating by one level. All participating parts must be numbered (when music is used) from beginning to end. Failure to have fully numbered parts will result in lowering of final rating by one level.

There will be one adjudicator per school when possible.

## Music Requirements

Note. There is no intent to dictate to the music director what is or is not suitable music for performance. However, here are some guidelines.

- A. It is suggested that high school events follow the OMEA Competition's Music Solo and Ensemble Listings in their selection of materials.
- B. It is suggested that junior high/middle school events follow the OMEA Competition's Music Solo and Ensemble Listings (Class "C") or other such suitable material.
- C. It is suggested that elementary events be especially careful not to choose music that is in the form of strictly band music or lesson book material. Attempt to choose music that is in the form of elementary solo and/or ensemble music written for the instrument or voice.

It is recommended that directors continue to search for a greater variety of literature appropriate to the venue and occasion and avoid as much as possible having more than three students playing the same composition at the event. We walk a thin line with the use of popular music.

- D. Please continue to watch the length of solos and ensembles, especially at the elementary and junior high/middle school level. It is strongly recommended that directors take into consideration that the length of literature to be heard should be long enough to allow for a thoughtful and thorough evaluation. It is recommended that at least four to five minutes of actual playing time be considered for elementary, and five to six minutes for junior high/middle and high school.
- E. It is recommended that all duets be true duets (having two parts). Please no "unisonettes."

- F. It is recommended that solo and ensembles be chosen for students on the basis of playability and musical education of the individual performer, rather than on the basis of the difficulty of the composition. Adjudicators are instructed to adjudicate ALL events on the basis of the musical performance of the composition performed without any outside factors. This means that each student will be adjudicated against his/her own ability to perform the composition in a musical manner. No “extra points” are given for the student who attempts a piece that is beyond his/her ability level.
- G. It is suggested that each contestant write his/her name and school on all music. Each student is responsible for obtaining his/her music from the room chair after performing. Music not picked up will be placed in the festival office in your school folder at the end of the day.

## Performance Stages

The public is welcome to listen to any of the performances under the following conditions:

1. **No** person shall enter or leave any performance room during the performance of a selection.
2. There will be **NO** talking, whispering, or other distractions from the time the soloist/ensemble takes position to perform until the end of the performance.
3. At the end of a performance, the audience may applaud if they wish.

**NOTE: The use of recordings and/or video or photographic equipment will NOT be permitted during any performance in any performance area.** This rule is in line with United States copyright law. An entire school district can be disqualified for failure to comply with this rule.

## Programs

Programs will be available at the registration desk for festival participants.

## Ratings

Ratings will be posted for all schools in the cafeteria.

- Rating of “I” This is an **outstanding** performance with very few technical errors and exemplifying a truly musical expression. This rating should be reserved for the truly musical outstanding performance.
- Rating of “II” This is an **excellent** performance in many respects, but not worthy of the highest rating due to minor defects in performance, ineffective interpretation, or improper instrumentation.
- Rating of “III” This is an **acceptable** performance but not outstanding. It shows accomplishment and marked promise but lacks one or more essential qualities.

## Ratings (cont.)

- Rating of “IV” This is a **poor** performance showing many technical errors, poor musical conception, lack of interpretation, incomplete instrumentation, or lacking in any of the other essential qualities.
- Rating of “V” This is a **very poor** performance indicating deficiencies in most of the essential factors and indicating that much careful attention should be given to the fundamentals of good performance. This rating should be used sparingly and only when it is possible to cite major faults.

## Scale Requirements

Scales are to be played evenly and smoothly at a tempo between 80 and 120 MM for the quarter note.

### Grades 4-5

Piano Solo	One scale, one octave, each hand separately, ascending and descending in any key selected by the soloist, with or without music.
String Solo	One scale, one octave, ascending and descending in any key selected by the soloist.

### Grade 6

Solo Instruments (piano, string, wind)	<b>One scale</b> , one octave, ascending and descending in any key of soloist’s choosing (piano—both hands together), without music or any help.
Drum solo	Single-stroke long roll or double-stroke long roll. Other percussion instruments, no rudiments. For percussion keyboard instruments, one scale, one octave, ascending and descending in any key of soloist’s choosing. For tunable percussion instruments, no scale requirements but need to demonstrate the ability to turn the instrument.
Vocal Solo and/or Ensemble	No scale requirements; all music must be memorized.

### Grades 7-8

Piano Solo	Two scales, two octaves, both hands together, ascending and descending, one in the same key as the solo, without music or any help.
Winds and Strings Solos	<b>Two scales</b> , one octave, ascending and descending, one in the same key as the solo.
Percussion Solo	One rudiment from this list of four: 1) single-stroke long roll, 2) double-stroke long roll, 3) five-stroke roll, or 4) flam. For percussion keyboard instruments, one scale, one octave, ascending and descending in any key of soloist’s choosing. For tunable percussion instruments, no scale required but need to demonstrate the ability to tune the instrument.
Vocal Solo and/or Ensemble	No scale requirements; all music must be memorized.



## Grades 9-12

Piano Solo	Two, two-octave scales, both hands together, ascending and descending, without music and any help, in two of the following keys: C, F, Bb, Eb, Ab, G, D, A, or E.
Winds, Strings, and Perc. Mallet	One-octave scale, ascending and descending, in one of the following keys for that instrument: C, F, Bb, Eb, Ab, G, D, A, or E. The soloist <u>may</u> elect to do two or more octaves if it is in a comfortable range for his/her instrument and shows off the student's Virtuosity Instrument Solos.
Percussion Solo	Two rudiments from this list of nine: 1) single-stroke long roll, 2) double-stroke long roll, 3) flam tap, 4) single flam tap, 5) single paradiddle, 6) ruff, 7) five-stroke roll, 8) seven-stroke roll, 9) nine-stroke roll. For percussion keyboard instruments, one scale, one octave, ascending and descending in any key of soloist's choosing. For tunable percussion instruments, no scale required but need to demonstrate the ability to tune the instrument.
Vocal Solo and/or Ensemble	No scale requirements; all music must be memorized.

## Time Schedule

- A. A maximum time limit of six minutes playing time will be permitted for any solo or ensemble. Adjudicators will have the authority to stop any performer who goes beyond that time limit.
- B. Adjudicating times will be as follows for all events.
1. Eight (8) minutes total for elementary level events
  2. Eight (8) minutes total for junior high/middle events
  3. Ten (10) minutes total for high school events
  4. Fifteen (15) minutes total for elementary bands and choirs

## Unloading and Parking

All activities will be held at **Buckeye High School**, 3084 Columbia Road, Medina. Students should enter the main entrance. Cars and buses should unload at the main entrance, then park in any of the school lots. Any car or truck blocking other vehicles or entrances will be moved from the lot at the owner's expense.

**NOTE: Taking audio or visual recordings will disqualify the event.**

**INSTRUMENTAL  
Room 101  
Amy Doty, Adjudicator**

Time	Event Type	District	Building	Teacher	Event Name	Composition	Composer	Rating
8:00 AM	Flute Solo	Highland	Middle School	E. Marquette	7th Grade Flute Solo	<i>Poeme Petite</i>	James C. LeWallen	_____
8:08 AM	Bells Solo	Highland	Middle School	N. Rudolph	8th Grade Mallet Solo	<i>Spinning Song</i>	A. Ellmenreich, arr. Art Jolliff	_____
8:16 AM	Clarinet Solo	Highland	Middle School	E. Marquette	7th Grade Clarinet Solo	<i>Chrysalis</i>	Gustave Langenus	_____
8:24 AM	Flute Solo	Highland	Middle School	N. Rudolph	8th Grade Flute Solo	<i>Scene from Swan Lake Ballet</i>	Tchaikowsky, arr. Harry Bluestone	_____
8:32 AM	Flute Solo	Highland	High School	E. Marquette	High School Flute Solo	<i>Andalouse</i>	Emile Pessard	_____
8:42 AM	Clarinet-Trumpet Duet	Highland	Middle School	E. Marquette	7th Grade Clarinet and Trumpet Duet	<i>Variations on a Shepherd's Tune</i>	O'Reilly/Williams	_____
8:50 AM	Flute-Mallet Duet	Highland	Middle School	E. Marquette	7th Grade Flute and Mallet Duet	<i>The King's Trumpets</i>	O'Reilly/Williams	_____
8:58 AM	Brass Trio	Highland	Middle School	E. Marquette	7th Grade Brass Trio	<i>Six Note Blues</i>	O'Reilly/Williams	_____
9:06 AM	Flute-Trumpet Trio	Highland	Middle School	E. Marquette	7th Grade Trio	<i>Old Joe Clark</i>	O'Reilly/Williams	_____
9:14 AM	Alto Sax Duet	Highland	Middle School	E. Marquette	7th Grade Alto Saxophone Duet	<i>Autumn</i>	Bender	_____
9:22 AM	Flute Duet	Highland	Middle School	E. Marquette	7th Grade Flute Duet	<i>The King's Trumpets</i>	O'Reilly/Williams	_____
9:30 AM	Trumpet Duet	Highland	Middle School	N. Rudolph	8th Grade Trumpet Duet	<i>Variations on a Shepherd's Tune</i>	arr. John O'Reilly/Mark Williams	_____
9:38 AM	Alto Sax Duet	Highland	Middle School	N. Rudolph	8th Grade Alto Saxophone Duet	<i>Theme</i>	Mozart, arr. Ostling/Weber	_____
9:46 AM	Clarinet Trio	Highland	Middle School	N. Rudolph	8th Grade Clarinet Trio	<i>Spring from "The Four Seasons"</i>	Vivaldi, arr. Pearson/Elledge	_____
9:54 AM	Alto Sax Duet	Highland	Middle School	N. Rudolph	8th Grade Alto Saxophone Duet	<i>The King's Trumpets</i>	arr. John O'Reilly/Mark Williams	_____
10:02 AM	Horn-Baritone Duet	Highland	Middle School	N. Rudolph	8th Grade Brass Duet	<i>Variations on a Shepherd's Tune</i>	arr. John O'Reilly/Mark Williams	_____

Time	Event Type	District	Building	Teacher	Event Name	Composition	Composer	Rating
10:10 AM	Snare Drum Quartet	Highland	Middle School	N. Rudolph	8th Grade Percussion Ensemble	<i>Quasi Bossa Nova</i>	Edward Marquette	
10:18 AM	Cello Solo	Highland	Middle School	L. Joss	8th Grade Cello Solo	<i>Ave Maria</i>	Traditional	_____

**NOTE: Taking audio or visual recordings will disqualify the event.**

**INSTRUMENTAL  
Room 504  
Michael McClintock, Adjudicator**

Time	Event Type	District	Building	Teacher	Event Name	Composition	Composer	Rating
8:00 AM	Percussion Ensemble	Brunswick	Middle School	G. Allen	BMS 8th-Period Percussion Ensemble	<i>Night Passage</i>	Bennett	_____
8:08 AM	Flute Solo	Brunswick	Middle School	G. Allen	Hailey Zielaskiewicz	<i>Fox Hunt</i>	Endresen	_____
8:16 AM	Flute Solo	Brunswick	Middle School	G. Allen	Lucy Till	<i>To a Wild Rose</i>	MacDowell	_____
8:24 AM	Snare Drum Solo	Brunswick	Middle School	G. Allen	Austin Woodards	<i>Grasshoppers and Pollywogs</i>	Hagedorn	_____
8:32 AM	Flute Solo	Brunswick	Middle School	G. Allen	Samantha Kral	<i>Allegretto</i>	Haydn	_____
8:40 AM	Percussion Ensemble	Brunswick	Middle School	G. Allen	BMS 9th-Period Percussion Ensemble	<i>Roll-Off Rhumba</i>	Firth	_____
8:48 AM	Brass Quintet	Brunswick	Middle School	G. Allen	BMS Brass Quintet	<i>Ode to Joy</i>	Beethoven	_____
8:56 AM	Marimba Solo	Brunswick	Middle School	G. Allen	Aaron Shienkaruk	<i>Ancient Ayre</i>	Barrett	_____
9:04 AM	Brass Quintet	Brunswick	Middle School	G. Allen	BMS 9th-Period Brass Quintet	<i>Calypso Morning</i>	Pearson	_____
9:12 AM	Alto Sax Solo	Brunswick	Middle School	G. Allen	Jacob Simon	<i>Dance Song</i>	Sperontes	_____
9:20 AM	Trombone Solo	Brunswick	Middle School	G. Allen	Johnathan Quinlan	<i>March</i>	Schumann	_____
9:28 AM	French Horn Solo	Brunswick	Middle School	G. Allen	Ryan Ballachino	<i>Springtime Waltz</i>	Behr	_____
9:36 AM	Baritone Solo	Brunswick	Middle School	G. Allen	Evan Myosky	<i>March from the Overture to "The Occasional Oratorio"</i>	Handel	_____
9:44 AM	Alto Sax Solo	Brunswick	Middle School	G. Allen	Zack Yuravak	<i>Minuetto</i>	Beethoven	_____
9:52 AM	Baritone Sax Solo	Brunswick	Middle School	G. Allen	Landon Bettis	<i>Polonaise</i>	Bach	_____
10:00 AM	Tenor Sax Solo	Brunswick	Middle School	G. Allen	Fiona Smith	<i>Dance Song</i>	Sperontes	_____

Time	Event Type	District	Building	Teacher	Event Name	Composition	Composer	Rating
10:08 AM	Bass Clarinet Solo	Brunswick	Middle School	G. Allen	Adalyn Hickling	<i>Polonaise</i>	Bach	
10:16 AM	Woodwind Quartet	Brunswick	Middle School	G. Allen	BMS Woodwind Quartet	<i>Calypso Morning</i>	Pearson	_____
10:24 AM	Bassoon Solo	Brunswick	Middle School	G. Allen	Allison Boyer	<i>Polonaise</i>	Bach	_____
10:32 AM	Baritone Solo	Brunswick	Middle School	G. Allen	Ellie Gorzalez-Ribble	<i>Bagatelle</i>	Diabelli	_____
10:40 AM	Flute Quartet	Brunswick	Middle School	G. Allen	BMS Flute Quartet	<i>Calypso Morning</i>	Pearson	
10:48 AM	Mixed Ensemble	Brunswick	Middle School	G. Allen	BMS Mixed Ensemble	<i>Courtly Dance</i>	Gastoldi	
10:56 AM	Low Reed Quartet	Brunswick	Middle School	G. Allen	BMS Low Reed Quartet	<i>Spring from "The Four Seasons"</i>	Vivaldi	_____
11:04 AM	Trombone Solo	Medina	Root MS	T. Pylinski	Daniel Cora	<i>Amythest</i>	Vandercook	_____
11:12 AM	Trumpet Solo	Buckeye	Jr. High School	G. King	Joe Stahl	<i>Rozinante</i>	Mike Hannickel	_____
11:20 AM	Clarinet Solo	Buckeye	Jr. High School	G. King	Kyla Posatierre	<i>Crabapple Crossing</i>	Ann Lindsay	
11:28 AM	Alto Sax Solo	Buckeye	Jr. High School	G. King	Joey Zika	<i>Nocturne</i>	Ann Lindsay	
11:36 AM	Trumpet Solo	Buckeye	Jr. High School	G. King	Morgan Haas	<i>Excursion</i>	Timothy Johnson	_____
11:44 AM	Clarinet Solo	Buckeye	Jr. High School	G. King	Katelyn Haney	<i>Habanera</i>	James Curnow	_____
11:52 AM	Flute Solo	Buckeye	High School	D. Woods	Emma Walters	<i>Fantasia 12</i>	Telemann	_____
12:02 PM	Clarinet Duet	Buckeye	Jr. High School	G. King	Anna Kosman and Delaney Weldon	<i>Bourre</i>	Handel	_____
12:10 PM	Baritone Duet	Buckeye	Jr. High School	G. King	Buckeye Jr. High Baritone Duet	<i>Waltz</i>	Keith Snell	
12:18 PM	Clarinet Solo	Buckeye	Jr. High School	G. King	Aurora Everly	<i>Danse Harlequin</i>	arr. Mark Hannickel	_____

**NOTE: Taking audio or visual recordings will disqualify the event.**

**STRINGS**  
**Room 106**  
**Michael Foster, Adjudicator**

Time	Event Type	District	Building	Teacher	Event Name	Composition	Composer	Rating
8:00 AM	Violin-Viola Duet	Highland	Middle School	L. Joss	6th Grade String Duet	<i>Big Rock Candy Mountain</i>	Robert Frost	_____
8:08 AM	Violin Duet	Highland	Middle School	L. Joss	7th Grade Violin Duet	<i>A Celebrated Duet</i>	I. Pleyel	_____
8:16 AM	Violin-Viola Duet	Highland	Middle School	L. Joss	7th Grade Violin-Viola Duet	<i>The Ash Grove</i>	Katheryn Greisinger	_____
8:24 AM	Violin-Cello Duet	Highland	Middle School	L. Joss	8th Grade String Duet	<i>Minuet</i>	Bach	_____
8:32 AM	Violin Solo	Highland	Middle School	L. Joss	8th Grade Violin Solo	<i>Violin Concert in A minor</i>	Vivaldi	_____
8:40 AM	Violin-Viola-Cello	Highland	Middle School	L. Joss	8th Grade String Trio	<i>Presto</i>	Haydn	_____
8:48 AM	Violin Duet	Highland	High School	L. Joss	9th Grade Violin Duet	<i>Minuet</i>	Bach	_____
8:58 AM	Violin-Cello Duet	Highland	High School	L. Joss	9th Grade String Duet	<i>A Dramatic Story</i>	Dancia	_____
9:08 AM	Violin-Viola Trio	Highland	High School	L. Joss	Sinfonia String Trio	<i>Overture from Sinfonia in C</i>	Marianna Martines	_____
9:18 AM	Violin-Cello Duet	Highland	High School	L. Joss	Camerata String Duet	<i>The Vagabond</i>	M. Gebaur	_____
9:28 AM	Violin-Cello Duet	Highland	High School	L. Joss	Sinfonia String Duet	<i>Symphony No. 36, Finale</i>	Mozart, arr. Latham	_____
9:38 AM	Violin Solo	Highland	High School	L. Joss	10th Grade Violin Solo	<i>Melody (from the movie "High Pass")</i>	M. Skoryk	_____
9:48 AM	Cello Solo	Highland	High School	L. Joss	9th Grade Cello Solo	<i>Minuet</i>	L. Boccherini	_____
9:58 AM	Violin Solo	Highland	High School	L. Joss	12th Grade Violin Solo	<i>Adelaide Violin Concerto in D, Mov. 1</i>	Mozart	_____
10:08 AM	Cello Solo	Highland	High School	L. Joss	11th Grade Cello Solo	<i>Kol Nidrei</i>	Max Bruch	_____

**NOTE: Taking audio or visual recordings will disqualify the event.**

**VOCAL and KEYBOARD  
Room 102  
Dan Doty, Adjudicator**

Time	Event Type	District	Building	Teacher	Event Name	Composition	Composer	Rating
8:00 AM	Piano Solo	Medina	Root MS	M. Kline	Molly Schachinger	<i>Für Elise</i>	Beethoven	_____
8:08 AM	Piano Solo	Brunswick	Kidder Elem	J. Timko	Cara Allen	<i>Melody Op. 101 No. 39</i>	Ferdinand Beyer	_____
8:16 AM	Piano Solo	Brunswick	Middle School	J. Timko	Ingrid Reynolds	<i>Ballade</i>	Burgmuller	_____
8:24 AM	Piano Solo	Brunswick	Middle School	J. Timko	Helena Poley	<i>Arabesque</i>	Burgmuller	_____
8:32 AM	Piano Solo	Brunswick	Middle School	J. Timko	Christian Dragan	<i>Le Courant limpide Op. 25</i>	Burgmuller	_____
8:40 AM	Vocal Ensemble	Buckeye	Jr. High School	P. Haberkorn	Buckeye Jr. High Vocal Ensemble	<i>A Candle's Light</i>	E. Rentz and H. Frombach	_____
8:48 AM	Vocal Solo	Buckeye	Jr. High School	P. Haberkorn	Angelina Vannello	<i>Clouds</i>	Andy Beck	_____
8:56 AM	Vocal Solo	Buckeye	Jr. High School	P. Haberkorn	Vivian Padilla	<i>Firefly</i>	Andy Beck	_____
9:04 AM	Vocal Solo	Buckeye	Jr. High School	P. Haberkorn	Piper Elliott	<i>Riversong</i>	Andy Beck	_____
9:12 AM	Vocal Solo	Buckeye	Jr. High School	P. Haberkorn	Leah Drees	<i>The Moon</i>	Andy Beck	_____
9:20 AM	Vocal Solo	Buckeye	Jr. High School	A. MacDonald	Aria Thomas	<i>Cardinal</i>	Andy Beck	_____
9:28 AM	Vocal Ensemble	Brunswick	Middle School	A. Albright	7th Grade SSA Ensemble	<i>She Sings</i>	Amy F. Bernon	_____
9:36 AM	Vocal Solo	Brunswick	Middle School	A. Albright	Breanna Bundy - Soprano	<i>Silent Noon</i>	Ralph Vaughn Williams	_____
9:44 AM	Vocal Solo	Brunswick	Middle School	A. Albright	Madelyn Ritter - Soprano	<i>Japanese Snow Song</i>	Brownsey/Lantz	_____
9:52 AM	Vocal Solo	Medina	Waite Elem	K. States	Adelaide Singleton	<i>The Mermaid</i>	Brendan Fox	_____
10:00 AM	Vocal Solo	Highland	Granger Elem	K. States	Sadie Valentine	<i>How Can I Keep From Singing?</i>	Robert W. Lowry	_____
10:08 AM	Vocal Solo	Medina	High School	K. States	Piper Hadad	<i>Gia il sole dal Gange</i>	Scarlatti	_____

Time	Event Type	District	Building	Teacher	Event Name	Composition	Composer	Rating
10:18 AM	Vocal Solo	Medina	Claggett MS	K. States	Eden Benz	<i>Danza, Danza, Fancuilla Gentile</i>	Durante	
10:26 AM	Vocal Solo	Medina	Root MS	K. States	Grace Urda	<i>The Fairy Pipers</i>	A. Herbert Brewer	_____
10:34 AM	Vocal Solo	Medina	Root MS	K. States	Natalie Spence	<i>Into the Night</i>	Clara Edwards	_____
10:42 AM	Vocal Solo	Cloverleaf	High School	K. States	Julia Nagy	<i>Loveliest of Trees</i>	John Duke	_____
10:52 AM	Vocal Solo	Highland	Sharon Elem	K. States	Morgan Lehman	<i>Molly Malone</i>	W. Rhys-Herbert	_____
11:00 AM	Vocal Solo	Buckeye	Jr. High School	K. States	Norah Woofter	<i>This Little Rose</i>	William Roy	
11:08 AM	Vocal Solo	Buckeye	High School	K. States	Issac Woofter	<i>Bright Is the Ring of Words</i>	R. Vaughan Williams	_____
11:18 AM	Piano Solo	Brunswick	Middle School	G. Allen	Allison Boyer	<i>Prelude Op. 28, No. 20</i>	Chopin	_____
11:26 AM	Vocal Solo	Medina	High School	E. Stauch	Lauren Wilson	<i>Caro mio ben</i>	Giordani	_____



## Special Thanks to Our Community Sponsors

# *Bauer* FUNERAL HOME

*Understanding When Needed Most*

Mary Ann Bauer

Charles D. Bauer

2089 Columbia Road • Valley City, Ohio 44280

(330) 483-3300 • FAX (330) 483-3254

[www.bauerfuneralhome1943.com](http://www.bauerfuneralhome1943.com)



*Martin Luther said, "Next to the Word of God, the noble art of music is the greatest treasure in the world." Students, keep making your beautiful music. We hope you all do well today.*

Zion Lutheran Church  
2233 Abbeyville Rd. Valley City  
[zionvc.org](http://zionvc.org)

***Special Thanks to Our Title Sponsors***

# **Buckeye Local Education Association**

**Fine Arts Education aids students in skills  
needed in the workplace: flexibility,  
the ability to solve problems  
and communicate,  
the ability to learn new skills,  
to be creative and innovative,  
and to strive for excellence.**

---

---

## **MEDINA COUNTY SOLO AND ENSEMBLE FESTIVAL**



# Special Thanks to Our Title Sponsors



## UPGRADE YOUR INSTRUMENT NOW

Our team of educational representatives is available to help you select the step-up instrument that is right for you.

- Large selection of Flutes, Clarinets, Saxes, Trumpets, Trombones, Euphoniums, & Tubas
- Armstrong, Bach, Buffet, Cannonball, Conn, DiZhao, Jupiter, Leblanc, P. Mauriat, Powell, Selmer, Yamaha
- Special Discounted Pricing
- Low Monthly Payment Options
- Appointments Available

**Sound Better, Play Faster**

# Special Thanks to Our Title Sponsors

## ROYALTON MUSIC CENTER

take a **minor** drive &  
experience a **Major** difference

Ohio's only  
**Top 100**  
Music  
Store  
Since 2011

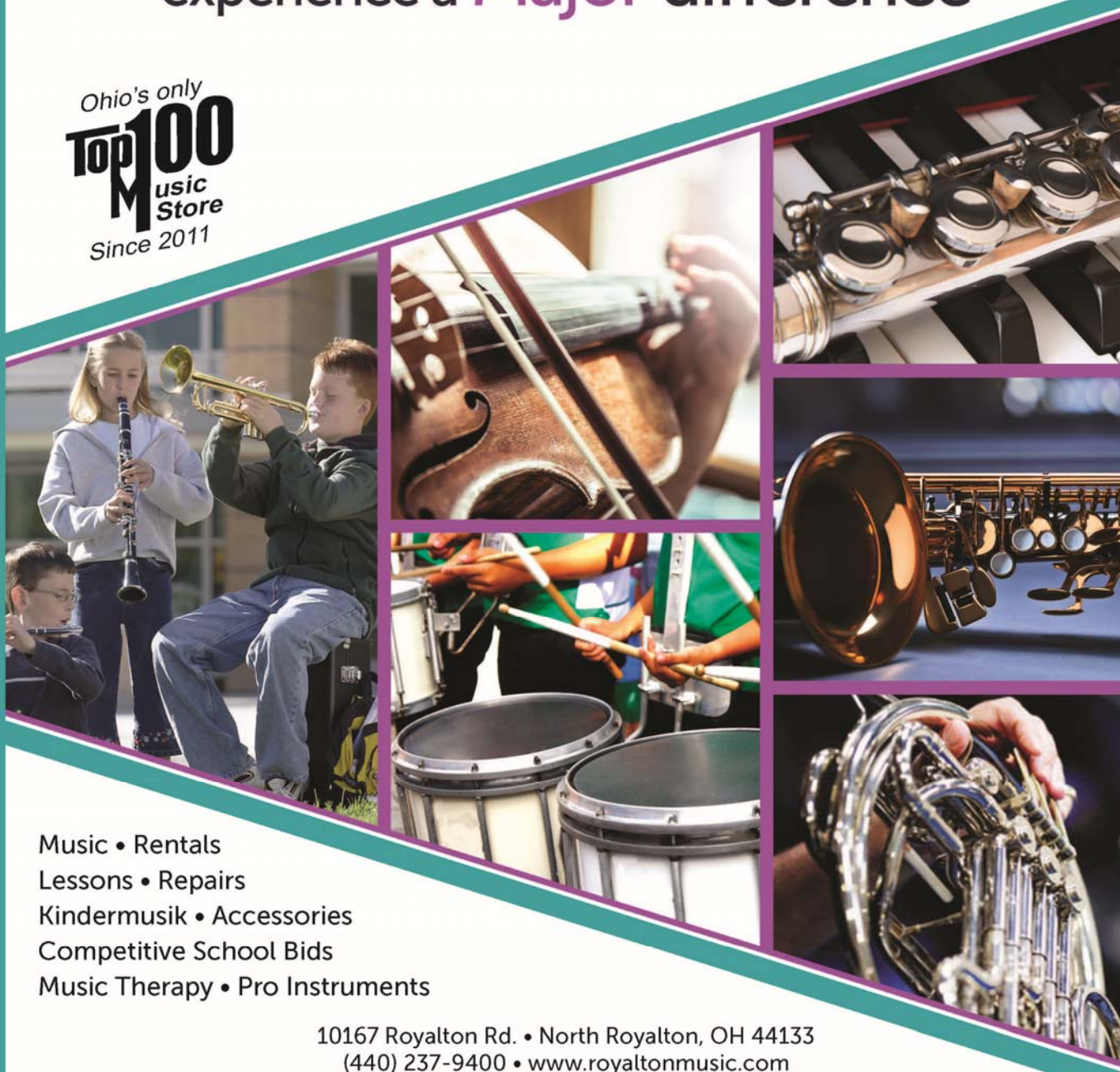

Music • Rentals  
Lessons • Repairs  
Kindermusik • Accessories  
Competitive School Bids  
Music Therapy • Pro Instruments

10167 Royalton Rd. • North Royalton, OH 44133  
(440) 237-9400 • [www.royaltonmusic.com](http://www.royaltonmusic.com)

***Special Thanks to Our Title Sponsors***

***SERPENTINI***  
***of Medina***



***Enjoy the Festival!***

***From your hometown***

***Chevy Dealer***

# Special Thanks to Our Title Sponsors

## *South Court Dental* **It's Not Just About Teeth**

South Court Dental welcomes you to a practice of skilled professionals. This all-female staff, led by Dr. Kate Cartwright and Dr. Karry Rogus, provides general dentistry and orthodontic services for adults and children. When you make an appointment there, be prepared to talk about more than just your teeth.

"Getting to know patients is one of the core values of our practice. That may seem old-fashioned in today's fast-paced medical environment, but it's just who we are," explains Dr. Cartwright.

There is nothing old-fashioned about the dentistry at South Court Dental. They provide the latest technology, including Invisalign® clear orthodontics and cosmetic dentistry.

If you are looking for a privately-owned dental practice that values high-quality, reliable dentistry, you will find a home at South Court Dental.



*Dr. Kate Cartwright, owner, and Dr. Karry Rogus*

*South Court Dental is located one mile south of the Medina Square on South Court Street.  
Call 330-725-0581 or visit [www.southcourtdental.com](http://www.southcourtdental.com) to schedule your appointment.*

***Special Thanks to Our Title Sponsors***

**VFW**

**Valley City Post 5563**

**6731 Center Road**

**Valley City, OH**

**(330) 483-3792**

**Thank A Vet!**

# WANTED

Dedicated young musicians and vocalists who would like to:

- \* Perform together,
- \* Practice hard, and
- \* Have a great summer experience.

**2024 Medina County Fair  
Honors Choirs, Bands, and Orchestra  
are looking for YOU!!!**

Rehearsals are being planned for  
July 22-31

With our concert at the  
Medina County Fair  
on August 1 at noon and 1 PM

Concert Band - Grades 4-6  
Elementary Choir - Grades 3-6

Symphonic Band - Grades 6-8  
Youth Choir - Grades 6-12

Orchestra - Grades 5-8

**If interested, contact your director by  
Monday, May 6, 2024.**