

MEDINA COUNTY
65th ANNUAL
SOLO AND ENSEMBLE FESTIVAL

BUCKEYE HIGH SCHOOL

THIS FESTIVAL IS HELD UNDER THE
AUTHORITY OF THE ESC OF MEDINA COUNTY
GOVERNING BOARD.

ROBERT A. HLASKO, ED.D., SUPERINTENDENT

JEFFREY D. HARRISON, SUPERINTENDENT
BUCKEYE LOCAL SCHOOLS

DANIEL FLOOD, PRINCIPAL
BUCKEYE HIGH SCHOOL

GREG KING, FESTIVAL CO-COORDINATOR

PAM HABERKORN, FESTIVAL CO-COORDINATOR



SATURDAY
JANUARY 28, 2023



THANK YOU

*The Buckeye Band Boosters Appreciate and
Thank You for Your Support.*

Coffee/Tea/Water	\$1.00
Donuts	\$2.00

Special Thanks to Our Individual Sponsors

Dr. Mary Crabtree

Melissa Miller

Casey Spangler

Brenda Zacharias



Educational Service Center of Medina County

"Stepping Up to Excellence"

The Educational Service Center of Medina County will be the leader in providing services and products that promote excellence in education.

Dear Students and Spectators:

Welcome to the 65th annual Medina County Solo and Ensemble Festival! Through the collaboration of the ESC of Medina County and music directors from the participating Medina County school districts, this event has provided a creative outlet in a competitive format for generations of talented students.

Whether in the classroom, on the field, or on the stage, Medina County students demonstrate amazing talents every year. The time and dedication these students (and their directors) put into their craft is beyond comprehension. I am certain this year's group of talented artists will no doubt impress us! The Solo and Ensemble Festival provides an ideal outlet for both individual and group performances in a setting of friendly competition. We encourage you to support each student and school in that manner.

A huge thank-you to Buckeye Local Schools for their efforts and for the generous use of their facilities for this event. It is a testament to the dedication of the educators and the schools they represent in coming together to plan for and facilitate an event such as this in order to put the spotlight where it belongs—on the amazing students of Medina County.

Finally, a thank-you to the audience for celebrating the students here today! Enjoy the show!

Sincerely,

Robert A. Hlasko, Ed.D.
Superintendent
ESC of Medina County



ADMINISTRATION

Jeffrey D. Harrison
Superintendent

Jennifer Knapp
Treasurer

Bridget M. Elias
Director of Curriculum

Dawn Kochanek
Director of Student
Services

Jon List
Director of Operations

BOARD OF EDUCATION

Seth Kujat
President

John Girard
Vice President

Rob Banaga
Member

Barb Gunkelman
Member

Denise Piovarchy
Member

BUCKEYE LOCAL SCHOOLS

BELIEVE • EMPOWER • ACHIEVE

January 20, 2023

Welcome!

On behalf of the administration, faculty and support staff at Buckeye Local Schools, I would like to welcome you to this year's Solo and Ensemble Festival. We are pleased to be your host.

Thank you to the many family members, instructors and music teachers who have encouraged the young musicians participating in this year's event. Your dedication to the education and personal growth of our young people is commendable.

Best wishes to today's participants. I hope you have a satisfying, rewarding and enjoyable experience.

Again, welcome to Buckeye Local Schools.

Sincerely,



Jeffrey D. Harrison
Superintendent



BUCKEYE HIGH SCHOOL

Mr. Daniel P. Flood
Principal

Mr. Adam Snook
Assistant Principal

Mrs. Amanda Hogue
School Counselor

Mrs. Jennifer Wish
School Counselor

Mrs. Maureen Maxwell
Administrative Assistant

Mrs. Alicia Shank
Administrative Assistant

Mrs. Yvonne Inman
Counseling Office
Assistant

Mr. Thomas Harrington
Athletic Director

Mrs. Marian Kashou
Athletic Office Assistant

BUCKEYE LOCAL SCHOOLS

BELIEVE • EMPOWER • ACHIEVE

Dear Students, Teachers, Parents and Guests:

It gives me great pleasure to welcome you to Buckeye High School for the Medina County Solo and Ensemble Contest. We are proud to host such an outstanding event, showcasing some of Medina County's most talented young musicians. This event continues to exemplify our mission of empowering students to compete in society. We know the hard work, dedication and hours of rehearsing will pay off with an excellent performance in today's contest.

Contests such as this one are a lot of work for everyone involved. A special thank-you to all the directors, teachers, parents and students for their efforts in putting this event together. As you participate in or watch the amazing performances today, be sure to thank all those who have given their time and energy to make the day a success.

Now is the time to sit back and enjoy the program. Let this be a positive experience in your musical endeavors, listen and learn from others and take the judge's comments and put them to good use. Once again, thank you all for supporting our young people in their quest for excellence.

Sincerely,

Daniel Flood
Principal
Buckeye High School

BUCKEYE HIGH SCHOOL

Floor Plan

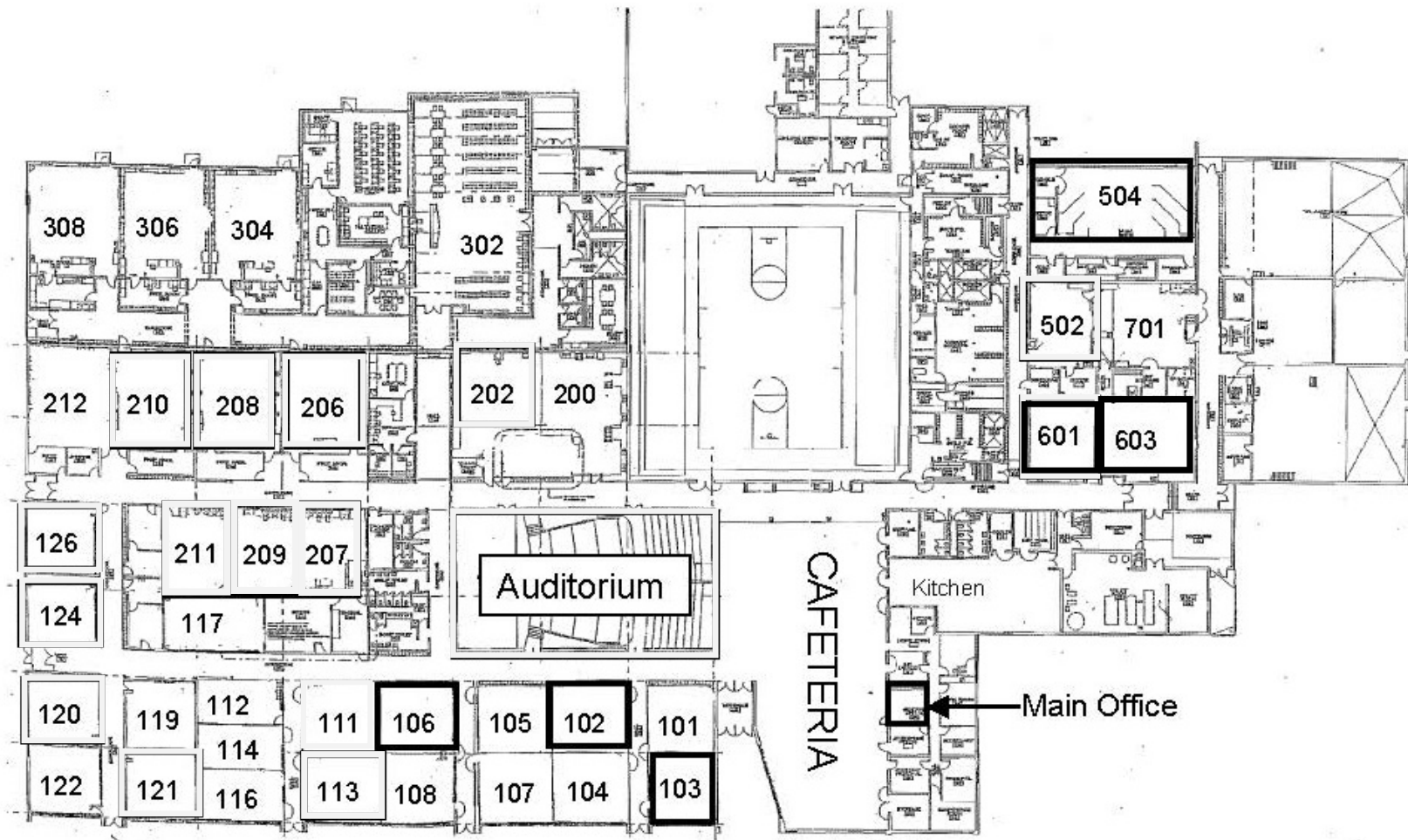

Adjudication Rooms

Room 102	Dan Doty
Room 103	Amy Doty
Room 504	Steve Hadgis

Warm-Up Rooms

Room 601	Instrumental
Room 603	Piano
Room 603	Vocal (Buckeye)
Room 106	Vocal (Highland)

Home Rooms

Buckeye (instrumental)	Room 601
Buckeye (vocal)	Room 603
Highland	Room 106
Medina	Room 601
Private	Room 106

Adjudicator Room

Main Office Adjudicators' Meeting Room

Table of Contents

Participating Schools and Adjudicators	ii
---	-----------

Rules and Regulations

A Note to Parents, Participants, and Directors	iii
COVID-19 Guidelines	iii
Comment Sheets	iv
Conduct	iv
Directions to Music Directors	iv
Event Cancellations, Conflicts, and Schedule Changes	v
Festival Management	v
Homerooms and Warm-Up Rooms	v
Music and Adjudicator's Score	vi
Music Requirements	vi
Performance Stages	vii
Programs	vii
Ratings	vii
Scale Requirements	viii
Time Schedule	ix
Unloading and Parking	ix

Adjudication Schedule

Instrumental -----	Steve Hadgis -----	Room 504	1
Vocal -----	Amy Doty -----	Room 103	2
Vocal/Keyboard -----	Dan Doty -----	Room 102	4

Special Thanks to Our Sponsors and Patrons

HOMEROOMS		WARM-UP ROOMS	
Buckeye (instrumental)	Room 601	Instrumental	Room 601
Buckeye (vocal)	Room 603	Piano	Room 603
Highland	Room 106	Vocal (Buckeye)	Room 603
Medina	Room 601	Vocal (Highland)	Room 106
Private	Room 106		
Adjudicators	Main Office		

Participating Schools and Directors

Buckeye Local Schools

Pam Haberkorn
Greg King
Alison MacDonald

Highland Local Schools

Emily Miller

Medina City Schools

Elena Hoffmann

Private Instructor

Kimberly States

Adjudicators

Amy Doty
Dan Doty
Steve Hadgis

Black River Local Schools
Private music teacher, Wadsworth
Coventry Local Schools

Festival Management

Pam Haberkorn
Greg King
Brenda Zacharias

Festival Co-Coordinator, Buckeye HS and JH
Festival Co-Coordinator, Buckeye HS and JH
Secretary, ESC of Medina County

RULES AND REGULATIONS

A Note to Parents, Participants, and Directors

Music directors and the Educational Service Center of Medina County have structured the Medina County Solo and Ensemble Festival so that it falls in line with the Ohio Music Education Association (OMEA) rules and guidelines for festival competitions. With that thought in mind, we are providing these festival rules and regulations for your information.

The Medina County Solo and Ensemble Festival provides music students in Grades 5-12 (and fourth-grade piano students) with the opportunity to perform, display their talents, and receive constructive comments as well as a rating for their performances by a qualified adjudicator. Students are eligible to participate if they are enrolled in a Medina County school district currently under contract with the ESC of Medina County for Fine Arts Festival services. For this school year, that includes: Black River, Brunswick, Buckeye, Cloverleaf, Highland, Medina, and St. Francis Xavier School.

Adjudicators will continue to take an active role in helping students grow as participants, whether they will be participating in the OMEA Solo and Ensemble Festival this year or simply attending our county festival. Further, the management of this festival urges directors to allow students to participate either for rating or for comments only in an attempt to encourage students to participate in the event. The festival is to be used as a tool for performance improvement while garnering positive musical experiences for young musicians.

Please take a moment to review the next few pages. If you have comments and/or suggestions on the running of this festival, please address your comments to:

Robert A. Hlasko, Ed.D.,
Superintendent
ESC of Medina County
330/723-6393

Greg King, Festival Coordinator
Buckeye High School
330/722-8257, Ext. 3038

COVID-19 Guidelines

The following guidelines are being established for the health and safety of everyone involved in this event. Your understanding and cooperation will be greatly appreciated.

- **Medina County Health Department**

Current recommended health guidelines will be followed.

- **ESC of Medina County**

1. If a student is not feeling well on the day of the event, he/she should contact his/her director and request to be excused from participating.
2. Masks will be available for those who may need one.

Comment Sheets

Music teachers and directors will be responsible for picking up rating sheets and adjudicator music from the main school office on the day of the event. Comment sheets and music not picked up on the day of the event will be sent to the music teacher/director via ESC courier mail during the week following the event.

Only the director or authorized personnel may pick up these sheets. Parents, guardians, and students will not be permitted to pick up any rating sheets.

Conduct

Please remind your students not to deface any property or remove posters/signs from the building. Please use trash containers for all waste materials. No food or beverage is allowed outside of the food serving area.

Students smoking, drinking, or using any form of illegal drugs will be disqualified from the festival and turned over to the legal authorities.

Directions to Music Directors

- A. Schools may send as many soloists and ensembles in any event as they desire. However, it is recommended that a student **NOT** enter more than three solo and/or ensemble events. A student may **NOT** compete in the same type of event more than once per year (e.g., flute solo).
- B. A group with **3-24 members** is considered an ensemble. A group with **25-60 members** will be considered an elementary choir or band.
- C. The total number of students enrolled in an elementary band or choir may participate as long as they rehearse as a choir and all come from the same school. Doubling of parts in all groups is permissible.
- D. Members of duets **MUST** be performing DIFFERENT parts (no unison playing/singing). A duet, by definition, means two performers, and no more than two performers will be considered a duet.
- E. Recorder solos and ensembles are permitted and will follow the same rules as for instrumental and vocal solos.
- F. The use of photographed or otherwise reproduced copies of published music, without permission of the publisher, is in violation of the ESC of Medina County's policy and United States copyright laws. In cases where scores are "out of print," the director may secure permission from the publisher to reproduce the scores. The director should present the letter of permission from the publisher or music dealer to the adjudicator.

- G. In determining eligibility for junior high/middle school students, if your school building houses sixth graders, your students are considered junior high/middle. If sixth graders are housed at the elementary level, sixth graders are considered as elementary students.
- H. Directors will be permitted to use CDs, MP3 recordings, or Smart Music Studio to assist with accompaniment. The decision will be the director's, and the director is responsible for bringing his/her own equipment.

Event Cancellations, Conflicts, and Schedule Changes

If you have any event cancellations, report them to the festival office as soon as you arrive at the festival site. A runner will notify the appropriate room chair of the cancellation(s).

Conflicts in scheduling should be reported to the appropriate room chairs first. If no solution seems evident, contact the site host or festival chair. Schedule changes will be at the option of the adjudicator.

Festival Management

- A. To be accepted, entries must be received by Friday, **January 13**.
- B. Any entry not completed correctly will be returned to the applicant's director.
- C. Directors are expected to be in attendance during the times that their students are participating. If this is impossible, someone from that school should be predetermined as "director of responsibility" for those students. Rating sheets will not be given to students or parents the day of the event.
- D. It is the responsibility of each director to notify the festival chair of any conflicts that might prevent the festival from running on time. Such conflicts will be honored **ONLY** if written notification on the application form is available.

Homerooms and Warm-Up Rooms

All contestants should report to their homerooms/warm-up rooms at least 20 minutes prior to their performance time. Contestants are expected to appear at their performance room at least one event prior to their scheduled time.

All cases, wraps, etc., should be taken to your assigned homeroom upon arrival at the festival site. Each school district shall be responsible for leaving its room(s) neat and clean. An adult representative or parent should be in your homeroom during the hours of your participation. The site school will take no responsibility for lost or stolen items.

Music and Adjudicator's Score

Contestants must submit full scores in ensemble events and satisfactory non-duplicated copies of solos. (A piano score for either IS acceptable.) The adjudicator will indicate the rating the performer deserves but must report on the rating sheet, for the benefit of the festival, if the copy submitted is satisfactory.

All manuscript ensemble scores must be accurate, readable, and complete. Refer all doubtful cases to the festival chair.

All adjudicator's scores must be numbered from beginning to end. Failure to have fully numbered adjudicator's scores will result in lowering of the final rating by one level. All participating parts must be numbered (when music is used) from beginning to end. Failure to have fully numbered parts will result in lowering of final rating by one level.

There will be one adjudicator per school when possible.

Music Requirements

Note. There is no intent to dictate to the music director what is or is not suitable music for performance. However, here are some guidelines.

- A. It is suggested that high school events follow the OMEA Competition's Music Solo and Ensemble Listings in their selection of materials.
- B. It is suggested that junior high/middle school events follow the OMEA Competition's Music Solo and Ensemble Listings (Class "C") or other such suitable material.
- C. It is suggested that elementary events be especially careful not to choose music that is in the form of strictly band music or lesson book material. Attempt to choose music that is in the form of elementary solo and/or ensemble music written for the instrument or voice.

We are all encouraged to explore a greater variety of literature for our students and avoid as much as possible having more than three students playing the same composition at the event. We walk a thin line with the use of popular music. It is recommended that directors continue to search for literature appropriate to the venue and occasion.

- D. Please continue to watch the length of solos and ensembles, especially at the elementary and junior high/middle school level. It is strongly recommended that directors take into consideration that the length of literature to be heard should be long enough to allow for a thoughtful and thorough evaluation. It is recommended that at least four to five minutes of actual playing time be considered for elementary, and five to six minutes for junior high/middle and high school.
- E. It is recommended that all duets be true duets (having two parts). Please no "unisonettes."

- F. It is recommended that solo and ensembles be chosen for students on the basis of playability and musical education of the individual performer, rather than on the basis of the difficulty of the composition. Adjudicators are instructed to adjudicate ALL events on the basis of the musical performance of the composition performed without any outside factors. This means that each student will be adjudicated against his/her own ability to perform the composition in a musical manner. No “extra points” are given for the student who attempts a piece that is beyond his/her ability level.
- G. It is suggested that each contestant write his/her name and school on all music. Each student is responsible for obtaining his/her music from the room chair after performing. Music not picked up will be placed in the festival office in your school folder at the end of the day.

Performance Stages

The public is welcome to listen to any of the performances under the following conditions:

1. **No** person shall enter or leave any performance room during the performance of a selection.
2. There will be **NO** talking, whispering, or other distractions from the time the soloist/ensemble takes position to perform until the end of the performance.
3. At the end of a performance, the audience may applaud if they wish.

NOTE: The use of recordings and/or video or photographic equipment will NOT be permitted during any performance in any performance area. This rule is in line with United States copyright law. An entire school district can be disqualified for failure to comply with this rule.

Programs

Programs will be available at the registration desk for festival participants.

Ratings

Ratings will be posted for all schools in the cafeteria.

- Rating of “I” This is a **superior** performance, meeting all criteria.
- Rating of “II” This is an **excellent** performance, meeting most criteria.
- Rating of “III” This is an **acceptable** performance, meeting at least 50 percent of the criteria.
- Rating of “IV” This is a **poor** performance, meeting few (if any) of the essential criteria.
- Rating of “V” This is a **very poor** performance, indicating deficiencies in most of the essential criteria.

Scale Requirements

Scales are to be played evenly and smoothly at a tempo between 80 and 120 MM for the quarter note.

Grades 4-5

Piano Solo	One scale, one octave, each hand separately, ascending and descending in any key selected by the soloist, with or without music.
String Solo	One scale, one octave, ascending and descending in any key selected by the soloist.

Grade 6

Solo Instruments (piano, string, wind)	One scale , one octave, ascending and descending in any key of soloist's choosing (piano—both hands together), without music or any help.
Drum solo	Single-stroke long roll or double-stroke long roll. Other percussion instruments, no rudiments. For percussion keyboard instruments, one scale, one octave, ascending and descending in any key of soloist's choosing. For tunable percussion instruments, no scale requirements but need to demonstrate the ability to turn the instrument.
Vocal Solo and/or Ensemble	No scale requirements; all music must be memorized.

Grades 7-8

Piano Solo	Two scales, two octaves, both hands together, ascending and descending, one in the same key as the solo, without music or any help.
Winds and Strings Solos	Two scales , one octave, ascending and descending, one in the same key as the solo.
Percussion Solo	One rudiment from this list of four: 1) single-stroke long roll, 2) double-stroke long roll, 3) five-stroke roll, or 4) flam. For percussion keyboard instruments, one scale, one octave, ascending and descending in any key of soloist's choosing. For tunable percussion instruments, no scale required but need to demonstrate the ability to tune the instrument.
Vocal Solo and/or Ensemble	No scale requirements; all music must be memorized.

Grades 9-12

Piano Solo	Two, two-octave scales, both hands together, ascending and descending, without music and any help, in two of the following keys: C, F, B \flat , E \flat , A \flat , G, D, A, or E.
Winds, Strings, and Perc. Mallet	One-octave scale, ascending and descending, in one of the following keys for that instrument: C, F, B \flat , E \flat , A \flat , G, D, A, or E. The soloist <u>may</u> elect to do two or more octaves if it is in a comfortable range for his/her instrument and shows off the student's Virtuosity Instrument Solos.
Percussion Solo	Two rudiments from this list of nine: 1) single-stroke long roll, 2) double-stroke long roll, 3) flam tap, 4) single flam tap, 5) single paradiddle, 6) ruff, 7) five-stroke roll, 8) seven-stroke roll, 9) nine-stroke roll. For percussion keyboard instruments, one scale, one octave, ascending and descending in any key of soloist's choosing. For tunable percussion instruments, no scale required but need to demonstrate the ability to tune the instrument.
Vocal Solo and/or Ensemble	No scale requirements; all music must be memorized.

Time Schedule

- A. A maximum time limit of six minutes playing time will be permitted for any solo or ensemble. Adjudicators will have the authority to stop any performer who goes beyond that time limit.
- B. Adjudicating times will be as follows for all events.
 - 1. Eight (8) minutes total for elementary level events
 - 2. Eight (8) minutes total for junior high/middle events
 - 3. Ten (10) minutes total for high school events
 - 4. Fifteen (15) minutes total for elementary bands and choirs

Unloading and Parking

All activities will be held at **Buckeye High School**, 3084 Columbia Road, Medina. Students should enter the main entrance. Cars and buses should unload at the main entrance, then park in any of the school lots. Any car or truck blocking other vehicles or entrances will be moved from the lot at the owner's expense.

NOTE: Taking audio or visual recordings will disqualify the event.

INSTRUMENTAL
Room 504
Steve Hadgis, Adjudicator

Time	Event Type	District	Building	Teacher	Event Name	Composition	Composer	Rating
8:30 AM	Saxophone Duet	Buckeye	Jr. High School	G. King	Skylyn Tinay and Elliana Cingel Sax Duet	<i>Marche Militaire</i>	Franz Schubert	_____
8:38 AM	Alto Sax Solo	Buckeye	High School	G. King	Angel Kopnicki	<i>Pantomime</i>	James Curnow	_____
8:48 AM	Trombone Duet	Buckeye	Jr. High School	G. King	Kymauna Timura and Reed Davis Trombone Duet	<i>Etude</i>	Keith Snell	_____
8:56 AM	Alto Sax Solo	Buckeye	Jr. High School	G. King	Gabriel Vick	<i>Skaters Waltz</i>	Douglas Court	_____
9:04 AM	Flute Solo	Buckeye	Jr. High School	G. King	Celeste Depew	<i>March Majestic</i>	Douglas Court	_____
9:12 AM	Flute Solo	Buckeye	High School	G. King	Emma Walters	<i>Romance</i>	Georges Brun	_____
9:22 AM	Flute Duet	Buckeye	Jr. High School	G. King	Emma Buday and Lila Ricker Flute Duet	<i>March from the Nutcracker and English Dance</i>	Tchaikovsky and Bach	_____
9:30 AM	Clarinet Solo	Buckeye	Jr. High School	G. King	Katelyn Haney	<i>Danse Harlequin</i>	Mike Hannickel	_____
9:38 AM	Trumpet Solo	Buckeye	Jr. High School	G. King	Amanda White	<i>Trumpet Voluntary</i>	Jeremiah Clarke	_____
9:46 AM	Snare Drum Solo	Buckeye	Jr. High School	G. King	Matche Diarrassouba	<i>Regiment of the Rudiments</i>	Timothy Johnson	_____
9:54 AM	Inst. Ensemble	Medina	Waite Elem	E. Hoffmann	Ralph E Waite Steel Pan Ensemble	<i>Panacea (original unpublished)</i>	Paul Corbiere (WMD)	_____

NOTE: Taking audio or visual recordings will disqualify the event.

VOCAL
Room 103
Amy Doty, Adjudicator

Time	Event Type	District	Building	Teacher	Event Name	Composition	Composer	Rating
8:00 AM	Vocal Solo	Medina	High School	K. States	Carleigh Jones	<i>Preguntale a las Estrellas</i>	Edward Kilenyi	_____
8:10 AM	Vocal Solo	Medina	Claggett MS	K. States	Lainey Miller	<i>El majo timido</i>	Enrique Granados	_____
8:18 AM	Vocal Solo	Medina	Claggett MS	K. States	Eden Benz	<i>This Little Rose</i>	William Roy	_____
8:26 AM	Vocal Solo	Cloverleaf	High School	K. States	Alyssa Bergman	<i>Sebben crudele</i>	Antonio Caldara	_____
8:36 AM	Vocal Solo	Buckeye	High School	K. States	Lexi Dacek	<i>Der Schmetterling</i>	Franz Schubert	_____
8:46 AM	Vocal Solo	Medina	High School	K. States	Piper Hadad	<i>Gia il sole dal gange</i>	Alessandra Sciorlatti	_____
8:56 AM	Vocal Solo	Medina	Blake Elem	K. States	Grace Urda	<i>The Secret</i>	Oley Speaks	_____
9:04 AM	Vocal Solo	Highland	Middle School	K. States	Lexie James	<i>El majo discreto</i>	Enrique Granados	_____
9:12 AM	Vocal Solo	Medina	High School	K. States	Lucinda Posner	<i>Come Ready and See Me</i>	Richard Hundley	_____
9:22 AM	Vocal Solo	Brunswick	High School	K. States	Maggie Romano	<i>Sure On This Shining Night</i>	Samuel Barber	_____
9:32 AM	Vocal Solo	Medina	Root MS	K. States	Emma Raulie	<i>To My First Love</i>	Hermann Lohr	_____
9:40 AM	Vocal Solo	Highland	Middle School	E. Miller	Alex Jarosewich	<i>A Spoonful of Sugar</i>	Sherman	_____
9:48 AM	Vocal Duet	Highland	Middle School	E. Miller	Aurora Sulzener and Faith Stiggins	<i>Can You Feel the Love Tonight</i>	Rice/John	_____
9:56 AM	Vocal Solo	Highland	Middle School	E. Miller	Gen Killian	<i>Never Enough</i>	Pasek and Paul	_____
10:04 AM	Vocal Ensemble	Highland	Middle School	E. Miller	The Elderz	<i>When I'm Sixty-Four</i>	Lennon and McCartney/Leavitt	_____
10:12 AM	Vocal Solo	Highland	Middle School	E. Miller	Gianna Hajek	<i>Defying Gravity</i>	Schwartz	_____
10:20 AM	Vocal Duet	Highland	Middle School	E. Miller	Caitlyn Kwiatkowski and Emily Burger	<i>Breaking Free</i>	Emerson	_____

Time	Event Type	District	Building	Teacher	Event Name	Composition	Composer	Rating
10:28 AM	Vocal Solo	Highland	Middle School	E. Miller	Aaliyah Reed	<i>Colors of the Wind</i>	Menken/Schwartz	
10:36 AM	Vocal Solo	Highland	Middle School	E. Miller	Tessa Brindel	<i>Tightrope</i>	Pasek and Paul	
10:44 AM	Vocal Solo	Highland	Middle School	E. Miller	Olivia Martello	<i>Let's Go Fly a Kite</i>	Sherman	
10:52 AM	Vocal Solo	Highland	Middle School	E. Miller	Stella Vodilko	<i>Over the Rainbow</i>	Arlen/Coates	
11:00 AM	Vocal Solo	Highland	Middle School	E. Miller	Libby Lutzko	<i>Popular</i>	Schwartz	

NOTE: Taking audio or visual recordings will disqualify the event.

**VOCAL and KEYBOARD
Room 102
Dan Doty, Adjudicator**

Time	Event Type	District	Building	Teacher	Event Name	Composition	Composer	Rating
8:30 AM	Vocal Ensemble	Buckeye	Jr. High School	Haberkorn/MacDonald	Buckeye Vocal Ensemble	<i>Carry the Light</i>	Andy Beck	_____
8:38 AM	Vocal Solo	Buckeye	Jr. High School	P. Haberkorn	McKenna Berthold	<i>Think On Me</i>	Alicia Scott	_____
8:46 AM	Vocal Solo	Buckeye	Jr. High School	P. Haberkorn	Vivi Padilla	<i>The Moon</i>	Andy Beck	_____
8:54 AM	Vocal Solo	Buckeye	Jr. High School	P. Haberkorn	Amanda White	<i>The Lighthouse</i>	Andy Beck	_____
9:02 AM	Vocal Solo	Buckeye	Jr. High School	P. Haberkorn	Piper Elliott	<i>Firefly</i>	Andy Beck	_____
9:10 AM	Vocal Solo	Buckeye	Jr. High School	P. Haberkorn	Norah Woofter	<i>Drink to Me Only With Thine Eyes</i>	Ben Jonson	_____
9:18 AM	Vocal Solo	Buckeye	Jr. High School	A. MacDonald	Abbye Lightle	<i>Love Has Eyes</i>	Henry Bishop	_____
9:26 AM	Vocal Solo	Buckeye	High School	A. MacDonald	Kathryn Mackey	<i>Butterflies</i>	Andy Beck	_____
9:36 AM	Vocal Solo	Buckeye	High School	A. MacDonald	Isaac Woofter	<i>Passing By</i>	Edward Purcell	_____
9:46 AM	Vocal Solo	Buckeye	High School	P. Haberkorn	Madison Belpulsi	<i>Riversong</i>	Andy Beck	_____
9:56 AM	Vocal Solo	Buckeye	High School	P. Haberkorn	Clare Bohan	<i>Caro Mio Ben</i>	Giordani	_____
10:06 AM	Vocal Solo	Buckeye	High School	P. Haberkorn	Grace Bohan	<i>O Rest In the Lord</i>	Mendelssohn	_____
10:16 AM	Piano Solo	Buckeye	Jr. High School	P. Haberkorn	Madison Kreeger	<i>Rewrite the Stars</i>	Pasek and Paul	_____
10:24 AM	Piano Solo	Buckeye	Jr. High School	P. Haberkorn	Aria Knight	<i>Pathetique, 2d Movement</i>	Beethoven	_____

Special Thanks to Our Community Sponsors

Bauer

FUNERAL HOME

Understanding When Needed Most

Mary Ann Bauer

Charles D. Bauer

2089 Columbia Road • Valley City, Ohio 44280

(330) 483-3300 • FAX (330) 483-3254

www.bauerfuneralhome1943.com

MACK'S INC.

LUMBER-GYPSUM



One on One Knowledgeable Service

Serving Medina County for over 70 years!

330-483-3121

6760 School St. Valley City OH 44280

www.macksincoho.com

Special Thanks to Our Community Sponsors

VFW Valley City Post 5563

**6731 Center Road
Valley City, OH
(330) 483-3792**

Thank A Vet!



Martin Luther said, "Next to the Word of God, the noble art of music is the greatest treasure in the world." Students, keep making your beautiful music. We hope you all do well today.

**Zion Lutheran Church
2233 Abbeyville Rd. Valley City
zionvc.org**

Special Thanks to Our Title Sponsors

Buckeye Local Education Association

**Fine Arts Education aids students in skills
needed in the workplace: flexibility,
the ability to solve problems
and communicate,
the ability to learn new skills,
to be creative and innovative,
and to strive for excellence.**

MEDINA COUNTY SOLO AND ENSEMBLE FESTIVAL



Special Thanks to Our Title Sponsors



KERRICOOK CONSTRUCTION, INC.

🏠 20355 Vermont Street
Litchfield, Ohio 44253

☎ Ph: 440.647.4200

📠 Fx: 440.647.4344

🌐 www.kerricook.com

**SPECIALIZING IN DESIGN-BUILD, REMODELING, AND REHABILITATION
OF EXISTING RETAIL STRUCTURES**

Special Thanks to Our Title Sponsors



take a **minor** drive &
experience a **Major** difference

Ohio's only
Top 100
Music
Store
Since 2011

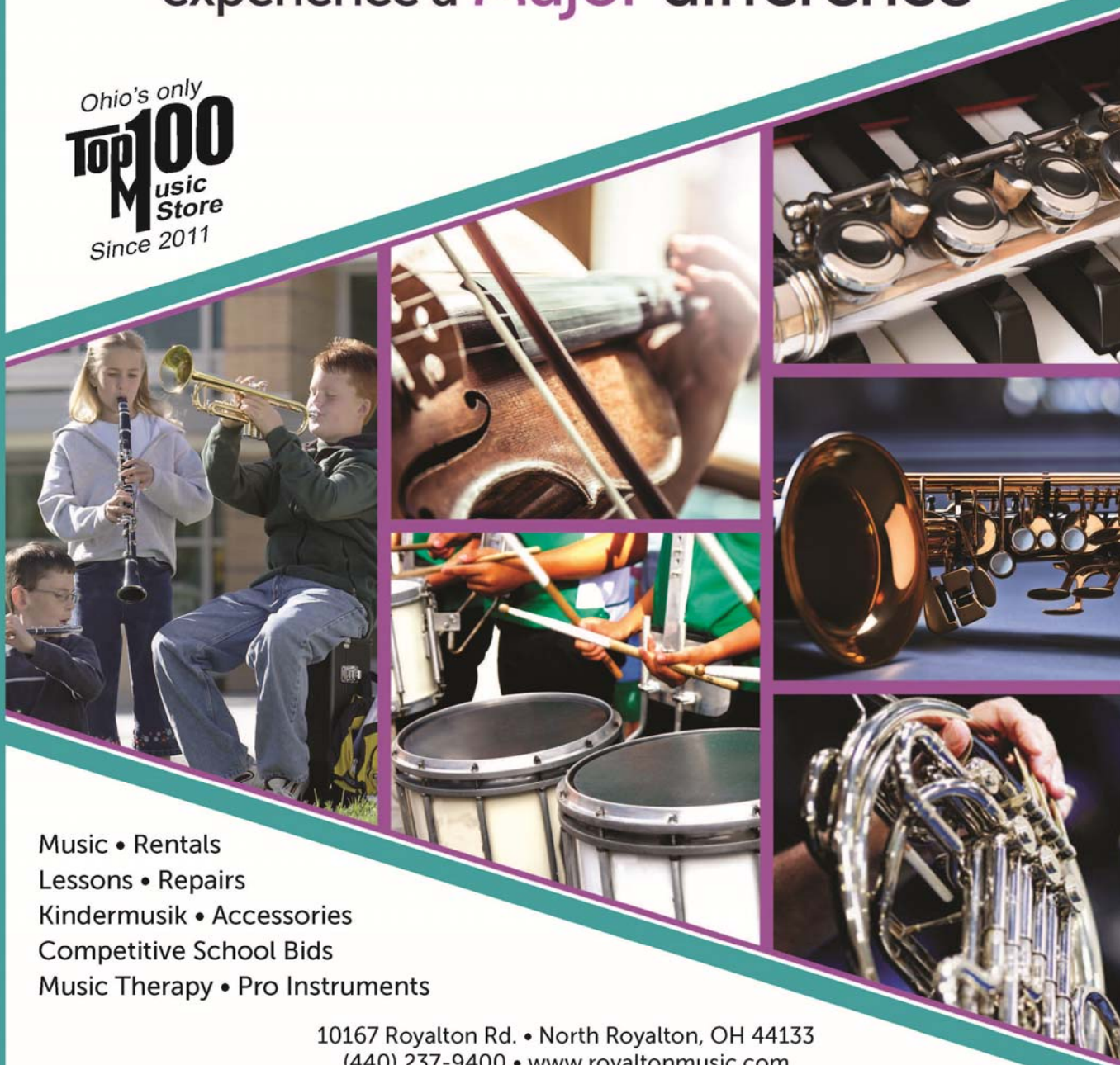

Music • Rentals
Lessons • Repairs
Kindermusik • Accessories
Competitive School Bids
Music Therapy • Pro Instruments

10167 Royalton Rd. • North Royalton, OH 44133
(440) 237-9400 • www.royaltonmusic.com

Special Thanks to Our Title Sponsors

SERPENTINI
of Medina



Enjoy the Festival!

***From your hometown
Chevy Dealer***

Special Thanks to Our Title Sponsors

South Court Dental **It's Not Just About Teeth**

South Court Dental welcomes you to a practice of skilled professionals. This all-female staff, led by Dr. Kate Cartwright and Dr. Karry Rogus, provides general dentistry and orthodontic services for adults and children. When you make an appointment there, be prepared to talk about more than just your teeth.

"Getting to know patients is one of the core values of our practice. That may seem old-fashioned in today's fast-paced medical environment, but it's just who we are," explains Dr. Cartwright.

There is nothing old-fashioned about the dentistry at South Court Dental. They provide the latest technology, including Invisalign® clear orthodontics and cosmetic dentistry.

If you are looking for a privately-owned dental practice that values high-quality, reliable dentistry, you will find a home at South Court Dental.



Dr. Kate Cartwright, owner, and Dr. Karry Rogus

*South Court Dental is located one mile south of the Medina Square on South Court Street.
Call 330-725-0581 or visit www.southcourtdental.com to schedule your appointment.*



Dedicated young musicians and vocalists who would like to:

- * Perform together,
- * Practice hard, and
- * Have a great summer experience.

**2023 Medina County Fair
Honors Choirs, Bands, and Orchestra
are looking for YOU!!!**

Rehearsals are being planned for
July 24 - August 2

With our concert at the
Medina County Fair
on August 3 at noon and 1 PM

Concert Band - Grades 4-6
Elementary Choir - Grades 3-6

Symphonic Band - Grades 6-8
Youth Choir - Grades 6-12

Orchestra - Grades 5-8

**If interested, contact your director by
Monday, May 1, 2023.**